

## Parts Breakdown

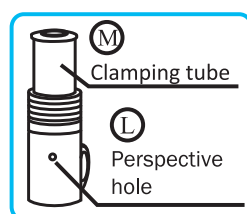
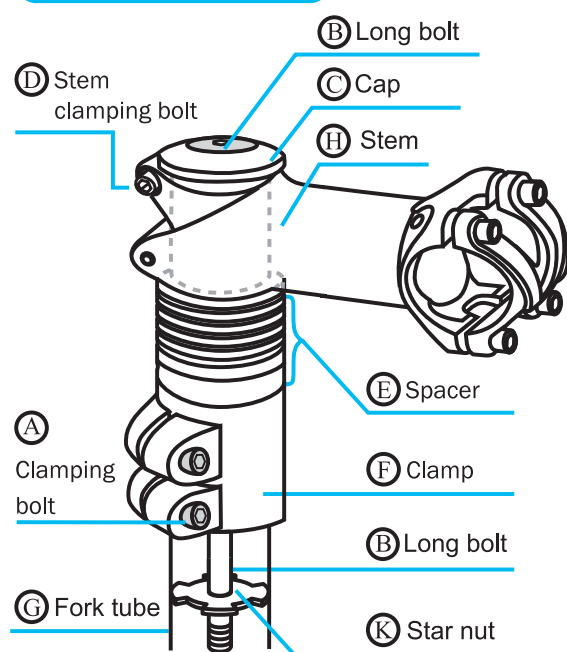

### Warning:

Always check carefully if all parts are securely tightened in place before every riding or after assembly. Contact professional SATORI dealer for any technical questions about it.

**satori**

# HEADS-UP4 USERS MANUAL



M6

[www.satoribike.com](http://www.satoribike.com)

## Installations of HEADS-UP4

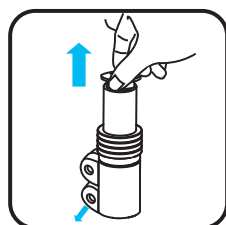

**1.** Remove top cap(C), clamping bolts(A), spacer (E), and long bolt(B) out of HEADS-UP4.

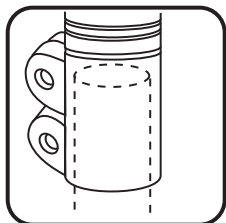

**2.** Place the clamp(F) onto the fork tube(G) with the inside fork tube can be seen through from the perspective hole(L).

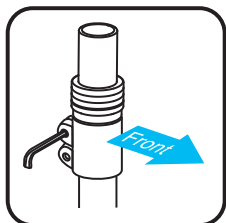

**3.** Pre-tighten the clamping bolts(A) to secure the HEADS-UP4 onto the fork tube(G).



**4.** Place the stem(H) onto clamping tube(M). Align HEADS-UP4, stem(H) and wheel in line, and then pre-tighten the clamping bolts of stem(D).

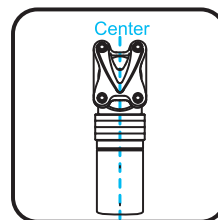

**5.** Make sure the stem(H), HEADS-UP4, at the center position and in line with the wheel and fork tube(G).

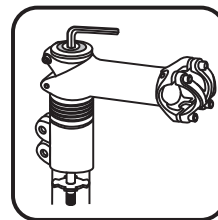

**6.** Place long bolt(B) onto the top of HEADS-UP. Gradually tighten up the long bolt(B) to secure HEADS UP onto the fork tube(G). **No movement between the product and fork tube (G) is allowed!**

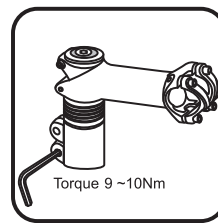

**7.** Gradually tighten up the clamping bolts of stem(D) and the HEADS-UP4 within torque 90~100 kgf-cm (9~10Nm).